

GENERAL NOTES:

1. ALL DIMENSIONS AND LEVELS SHALL BE CHECKED ON SITE PRIOR TO COMMENCEMENT OF WORK.
2. ALL LANDSCAPE DRAWINGS TO BE READ IN CONJUNCTION WITH ALL RELEVANT ENGINEER'S AND ARCHITECT'S DRAWINGS AND ALL DRAWINGS TO BE READ IN CONJUNCTION WITH THE LANDSCAPE SPECIFICATION.
3. ALL DIMENSIONS IN MILLIMETRES UNLESS NOTED OTHERWISE.
4. REFERRED TO THE DRAWING SPECIFICATION.
5. ALL DIMENSIONS IN MILLIMETRES UNLESS NOTED OTHERWISE.
6. DO NOT SCALE OFF THIS DRAWING.
7. EXISTING SERVICE ALIGNMENTS SHALL BE CHECKED ON SITE BY THE LANDSCAPE ARCHITECT PRIOR TO COMMENCEMENT OF WORK.
8. THE CONTENT OF THIS DRAWING IS TO BE READ IN CONJUNCTION WITH THE LATEST PROJECT CDM RISK REGISTER.

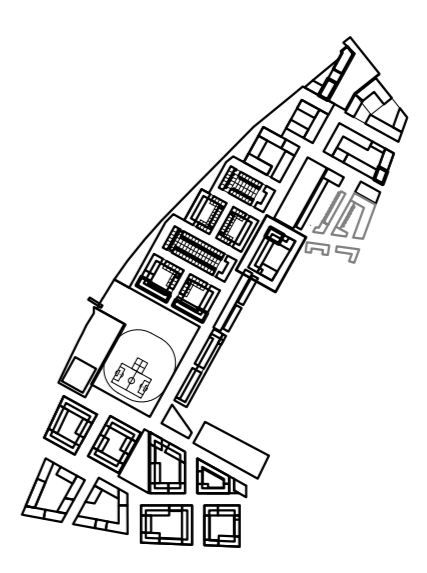

LOCATION PLAN:

LEGEND:

- Block Masonry base with brickwork and stone chippings including coarse. Edge treatments: upstand kerb edges and fins to all patios, path edges and lawn trims to be kerbs, Colour Grey, 75mm depth proprietary G1.
- Awnery lawn turf placed over min. 150mm depth proprietary lightweight soil.
- Flowering lawn turf placed over min. 150mm depth proprietary lightweight soil.
- Proposed planting bed raised above ground level with min. 400mm depth proprietary lightweight soil.
- Raised bed with pebbles, herbaceous planting and flowering trees.
- New planting bed - ornamental grasses with small tree / large shrub planting.
- Evergreen ground cover with highlight bulbs, herbs and grasses.
- Loose gravel maintenance access path to building facade.
- Extent of vertical ventilation outlets.
- Approximate alignment of level change within podium slab.
- Proposed fruiting or flowering tree planting with seasonal interest planted within min. 750mm depth proprietary lightweight soil.
- Proposed specimen fruiting or flowering tree planting within min. 750mm depth proprietary lightweight soil.
- Climbing plants with herbaceous ground cover.
- Raised timber planter with timber coping seal.
- Proprietary timber and metalwork bench rest.
- 2000mm x 400mm, with back and arm rest.
- Balanced lighting to primary routes. To Engineer's standard and specification.
- Proprietary play sculpture.

Rev	Date	Description	HY	CH
00	22/08/2014	Planning	HY	CH

grant associates
 Landscape Architecture, Urban Design, Creative Ecology
 22 Milk Street, Bishops Cleeve, L1 1JG
 T: +44 (0) 1255 334664, F: +44 (0) 1255 420893
 E: info@grant-associates.co.uk

CLIENT
 Redrow Homes Ltd.

PROJECT
 Peel Centre, Colindale
 Stage 1

TITLE
 Podium Gardens - Block H
 General Arrangement Plan

Scale: 1:100 @ A1
 Date: 07/08/2014
 Drawn: HV
 Checked: CH
 Approved: PC
 Status: Planning
 Drawing Number: PC398-P01-GE-02-1-001-P
 Rev: 00