

Notes:  
 © Felden Clegg Bradley Studios LLP  
 Internal furniture layouts for illustrative purposes only

Amendment  
 1 Issued for Planning

Date  
 27.08.2014

Job/Drawing No  
 1735-FCB-ZQ-0207

Amendment  
 P1

Peel Centre Colindale - Plot Q  
**Level 7 - GA Plan**

Scale 1:100 @ A0  
 Date Aug 2014  
 Drawn Studio 26

PLANNING

27.08.2014

All Dimensions to be checked on site

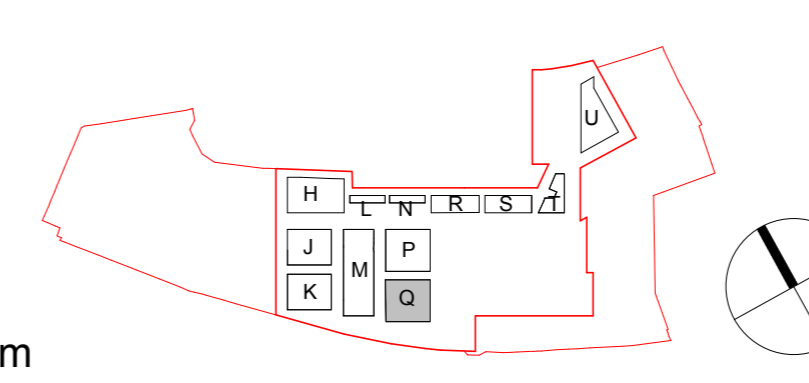

FeldenCleggBradleyStudios  
 LLP  
 Twenty Tottenham Street  
 London  
 W11 4RF  
 t +44 (0)20 7325737  
 e london@fcbstudios.com